

## Frequently Asked Questions

- **What age must a child be to travel in a CanaDream RV?**

Children of any age are welcome to travel in our RVs. It is the Parent/Guardian's responsibility to ensure all children are properly secured in an appropriate child restraint device for their weight and height.

- **Which types of seat belts are in the rear of CanaDream RV's?**

The rear cabins of our RVs are equipped with lap belts only.

- **In addition to side-facing and rear-facing seats, are there forward-facing seats in the rear cabin of CanaDream RV's?**

Yes. There are forward-facing seats in the dinette or on the rear sofa. The number of forward-facing seats in the rear cabin differs based on the type of vehicle rented. For further detail, please reference the table below.

- **Is it possible to deactivate the front passenger seat airbag in a Canadream vehicle?**

No. It is not possible to deactivate the front passenger seat airbag in any of our RVs.

- **Is it possible to move the front passenger seat backwards in a Canadream vehicle to create more space between the airbag and a child passenger?**

No. The front seat cannot move back far enough. Child restraints must not be used in the front passenger seat.

- **Do CanaDream RV's contain tether points or anchors?**

Our Motorhomes contain 2 tether points, the Van Conversion does not have any tether hooks, The Maxi Travel Camper trucks have ISOFIX anchor points. For further detail, please reference the table below.

- **Who is responsible for fitting the child restraint device in the vehicle?**

It is the Parent/Guardian's responsibility to fit the child restraint device in the vehicle. The Parent/Guardian should ensure all children are properly secured in an appropriate child restraint device.

- **Do you have child restraint devices available for rent?**

All CanaDream stations offer the Evenflo Symphony 3-in-1 child restraints (Infant Seats, Child Seats & Booster seat) available to rent for a fee. Our child restraints meet Canadian manufacturer safety standards. We recommend advance booking to ensure availability. Guests are required to sign a waiver at time of check in for the rental of the child seat.

- **Can a Booster Seat Be Used in a CanaDream RV?**

Yes, a Booster seat can (not a booster cushion) but please be aware that the rear seats in our Motorhomes contain only lap belts.

- **Can Parents/Guardians bring their own child restraint device?**

Yes. Guests can bring their own child restraint device.

Child Restraint Guide		Maximum # per seat category per vehicle type			
		TCA	DVC	SVC	MHC/MHB/MHL/MHA/MHX
# Tether Points		3	0	2	2
Recommended Restraint Capacity		3	0	2	2
Rear Facing Infant Seat	Age: Newborn to 1 Year old <i>and</i>	3	2	1	1
	Weight: up to 20lbs				
Child Seat	Age: 1 up to 7 years old <i>or</i>	3	2	2	2
	Weight: up to 40 lbs				
Booster Seat	Age: up to 7 years old <i>or</i>	3	2	2	2
	Weight: 80lbs or 145cm in height				

TCA: Trucks have isofix/anchor points.  
DVC: No fixed tether points/ Child Seat/Booster Seat is not recommended.  
SVC, MHC, MHB, MHL, MHA, & MHX: Equipped with 2 tether points and the Child/Booster Seats are secured by the lap belts. The Infant Seat is fixed in the reverse position by the lap belt only.  
*The recommended capacity is CanaDream's suggestion only. Whilst an RV can accommodate more, this would be at the discretion of the Parent/Guardian.*

**Position of tether points-** *Note: floor plans only depict tether point locations, not to be used for RV features/fixtures as they may vary. Where multiple floor plans exist, there is no Guest choice.*

## SVC

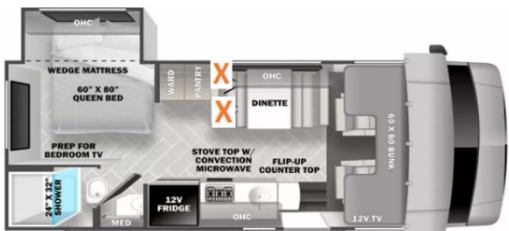

## MHC

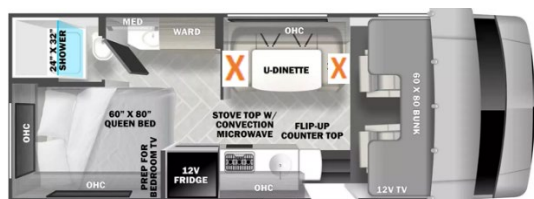

## MHB



## MHL



## MHA

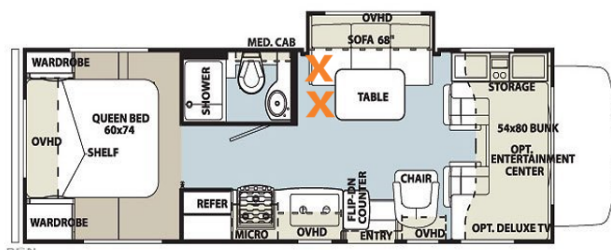

## MHX

